



## Aluminum Clad Wood — Installation Instructions

### New Construction Installation Instructions

- Preparations:** All framing members must conform to Industry standards. Recommend using a pre-stain on the interior wood pieces. Be sure to remove all staples that secure the nailing fin to the frame. **The nailing fin is to be used for alignment purposes only, not for structural support.**
- Set window in rough opening from outside with nailing fin over lapping exterior sheathing. Provide a continuous bead of sealant between the nailing fin and the exterior sheathing. Press the fin into the sealant before nailing. Center and level the window within the rough opening using shims where necessary. As you shim the window the nailing fin should be secured with a 1 3/4" long roofing nail.
- Install (wood or plastic) shims to center the window between the head and the sill (**Figure 1**).
- Plumb side jamb of window, be sure to check both side-to-side and front-to-back alignment. Shim if necessary. Secure the rest of nailing fin all the way around using 1 3/4" long roofing nails; 3" x 6" from each corner and no more than 24" on center in between.
- Now secure the window from the inside with a #8 penny finishing nail or longer (**Figure 2**). **Be sure to keep the nail within 1/2" of the wood stop to ensure proper penetration to the 2 x framing.** Nailing should start within one inch from each corner and spaced no more than 8" on center. (Be sure penetrate shims with the finishing nails and not let them slide out of position.) **All nails should be driven perpendicular to the frame.**
- Install nailing fin corner gaskets in all four corners.
- Install 9" flashing strips over the nailing fin as shown in **Figure 3**. Apply underlay (such as building paper) in a shingled (overlapping) pattern or follow industry standards for window flashing.
- After exterior siding or brick is applied, caulk around perimeter of window unit. (When brick veneer is used as exterior finish, adequate clearance must be left for caulking between the window sill and masonry. This will prevent damage and bowing of sill caused by shrinkage and settling of structural lumber.)

### LightWise® Aluminum Clad Wood Windows Sizing Chart

*Nominal Glass Block Panel Size	**Required Rough Opening Size (width x height)	*Nominal Glass Block Panel Size	**Required Rough Opening Size (width x height)	*Nominal Glass Block Panel Size	**Required Rough Opening Size (width x height)
16" x 16"	18 1/2" x 18 1/2"	32" x 32"	34" x 34"	48" x 56"	49 3/8" x 57 3/8"
16" x 24"	18 1/2" x 26 1/4"	32" x 40"	34" x 41 1/16"	48" x 64"	49 3/8" x 64 15/16"
16" x 32"	18 1/2" x 34"	32" x 48"	34" x 49 3/8"	56" x 16"	57 3/8" x 18 1/2"
16" x 40"	18 1/2" x 41 11/16"	32" x 56"	34" x 57 3/8"	56" x 24"	57 3/8" x 26 1/4"
16" x 48"	18 1/2" x 49 3/8"	32" x 64"	34" x 64 15/16"	56" x 32"	57 3/8" x 34"
16" x 56"	18 1/2" x 57 3/8"	32" x 72"	34" x 72 1/16"	56" x 40"	57 3/8" x 41 11/16"
16" x 64"	18 1/2" x 64 15/16"	32" x 80"	34" x 80 1/2"	56" x 48"	57 3/8" x 49 3/8"
16" x 72"	18 1/2" x 72 1/16"	40" x 16"	41 11/16" x 18 1/2"	56" x 56"	57 3/8" x 57 3/8"
16" x 80"	18 1/2" x 80 1/2"	40" x 24"	41 11/16" x 26 1/4"	64" x 16"	64 15/16" x 18 1/2"
24" x 16"	26 1/4" x 18 1/2"	40" x 32"	41 11/16" x 34"	64" x 24"	64 15/16" x 26 1/4"
24" x 24"	26 1/4" x 26 1/4"	40" x 40"	41 11/16" x 41 11/16"	64" x 32"	64 15/16" x 34"
24" x 32"	26 1/4" x 34"	40" x 48"	41 11/16" x 49 3/8"	64" x 40"	64 15/16" x 41 11/16"
24" x 40"	26 1/4" x 41 11/16"	40" x 56"	41 11/16" x 57 3/8"	64" x 48"	64 15/16" x 49 3/8"
24" x 48"	26 1/4" x 49 3/8"	40" x 64"	41 11/16" x 64 15/16"	72" x 16"	72 11/16" x 18 1/2"
24" x 56"	26 1/4" x 57 3/8"	40" x 72"	41 11/16" x 72 1/16"	72" x 24"	72 11/16" x 26 1/4"
24" x 64"	26 1/4" x 64 15/16"	48" x 16"	49 3/8" x 18 1/2"	72" x 32"	72 11/16" x 34"
24" x 72"	26 1/4" x 72 1/16"	48" x 24"	49 3/8" x 26 1/4"	72" x 40"	72 11/16" x 41 11/16"
24" x 80"	26 1/4" x 80 1/2"	48" x 32"	49 3/8" x 34"	80" x 16"	80 1/2" x 18 1/2"
32" x 16"	34" x 18 1/2"	48" x 40"	49 3/8" x 41 11/16"	80" x 24"	80 1/2" x 26 1/4"
32" x 24"	34" x 26 1/4"	48" x 48"	49 3/8" x 49 3/8"	80" x 32"	80 1/2" x 34"

NOTES: \*Based on 8" x 8" nominal sized glass block. \*\*Rough Opening = Actual Size + 3/4".

### INSTALLATION & CLEANING RECOMMENDATIONS

- Use a detergent-water solution and a soft rag or brush to remove dust, dirt, smoke film, soot or salt spray away from aluminum frame surfaces.
- For glass surfaces, follow common window-cleaning procedures using warm soapy water or a branded glass cleaning product.
- Protect LightWise® Windows from power washing and acid cleaning of surrounding walls.

### Finishing Accessory

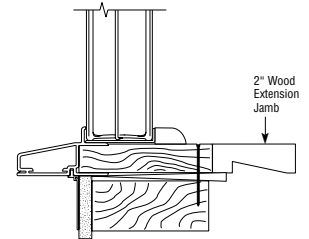

Sill Detail for Optional 2 x 6 Construction

### Safety Glazing Test

ANSI Z97.1	Passed 12", 18" and 48" drops
CPSC-16-CFR 1201	Passed 48" drop

### AAMA/NWWDA 101/I.S. 2-97

AAMA Designation	Air Test (PSF)	Water Test (PSF)	Design Load (PSF)
F-LC 90 - 56 x 56	6.24	12.00	90.0
F-LC 90 - 32 x 80	6.24	12.00	90.0

The information contained herein is accurate and reliable to the best of our knowledge. But, because Pittsburgh Corning Corporation has no control over installation workmanship, accessory materials or conditions of application, NO EXPRESS OR IMPLIED WARRANTY OF ANY KIND, INCLUDING THOSE OF MERCHANTABILITY OR FITNESS FOR A PARTICULAR PURPOSE, IS MADE as to the performance of an installation containing Pittsburgh Corning products. In no event shall Pittsburgh Corning be liable for any damages arising because of product failure, whether incidental, special, consequential or punitive, regardless of the theory of liability upon which any such damages are claimed. Pittsburgh Corning Corporation provides written warranties for many of its products, and such warranties take precedence over the statements contained herein.



800 Presque Isle Drive  
Pittsburgh, PA 15239  
724-327-6100

LightWise® logo is a registered trademark owned and protected by Pittsburgh Corning Corporation, Pittsburgh, PA 15239 © 2005 Pittsburgh Corning Corporation

### Renovation Installation procedures will follow the same steps as New Construction Installation.

On some renovation installations, the integral nailing fin may have to be removed to insert the LightWise® Window into the existing opening. Score the fin with a razor knife and snap it off. **Figure 4** shows a window with the nailing fins removed.

**NOTE:** All drawings are for illustration purposes only to aid the installer.

